

the "D" fender

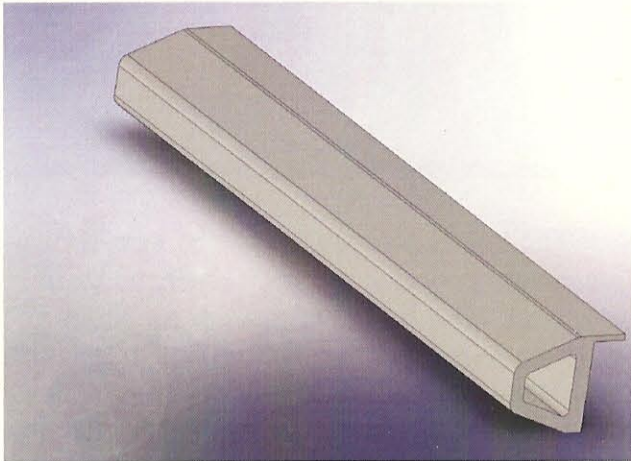

The D-FENDA profile allows for easy fitting to the top of the pontoon designed to protect the boat from contact with the dock whilst moored, the flexibility of these fenders allows for fitting on curved/angled faces as well as straight.



corner fender



The corner fender is a robust protector mounted on the front face of the corner of the pontoon, this is the area that can cause the majority of damage to a boat when mooring. Easily screw fixed to the pontoon in minutes, which when used in conjunction with the corner guide post, assists in easier and safer mooring.



short and flexible

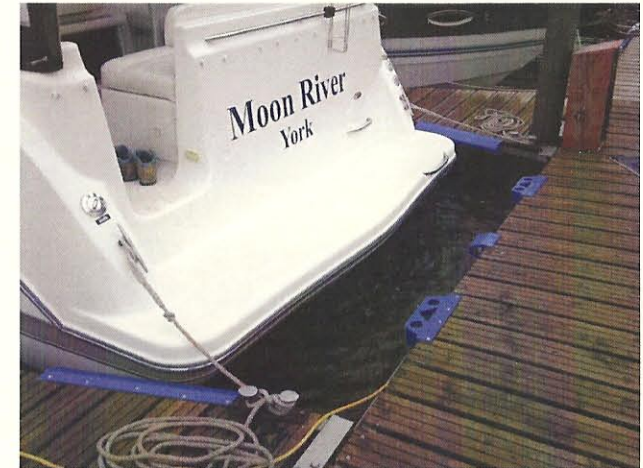

The short fender can be used as a stern/side fender or simply remove the centre membrane and this fender can be used on corners up to and over 90°. A versatile fender that is robust and easy to attach.

